



Butterfly valves are ideal for use as throttling valves. With the 10-position index plate, it is easy to repeat consistent flow conditions. Compact in design, this valve is used when space is at a premium.

Like the true union, this valve is ideally suited for the most demanding industrial, commercial, agricultural and irrigation environments.



See page 73 for valve actuation. This catalog contains information on parts offered at the date of printing. Please refer to our current list price sheets for any additional parts or sizes now offered.



Each and every butterfly valve is tested under high pressure for structural integrity and low pressure for a bubble-tight seal.

CUSTOMER SERVICE
Michigan (800) 374 0234
Florida (800) 432 6224
www.colonialengineering.com



■ **Dri-Shaft™ Technology**
 Only the disc, body and seals come in contact with the fluid stream, not the stainless steel stem/shaft. The stainless steel stem/shaft stays dry and out of the fluid stream at all times. *Beware, some look-alike butterfly valves have wet shafts. Insist on Colonial's Dri-Shaft™ technology.*

■ **Single Offset Disc**
 Disc and seat design produces minimal wear for long-life and maximum performance.

■ **Body and Disc Materials: PVC**

■ **Seal Materials: EPDM**

■ **Pressure Rating**
 Full 150 psi pressure rated Class 150 design.

Also rated for vacuum service. Bolt pattern meets ANSI, DIN and AWWA dimensional standards.

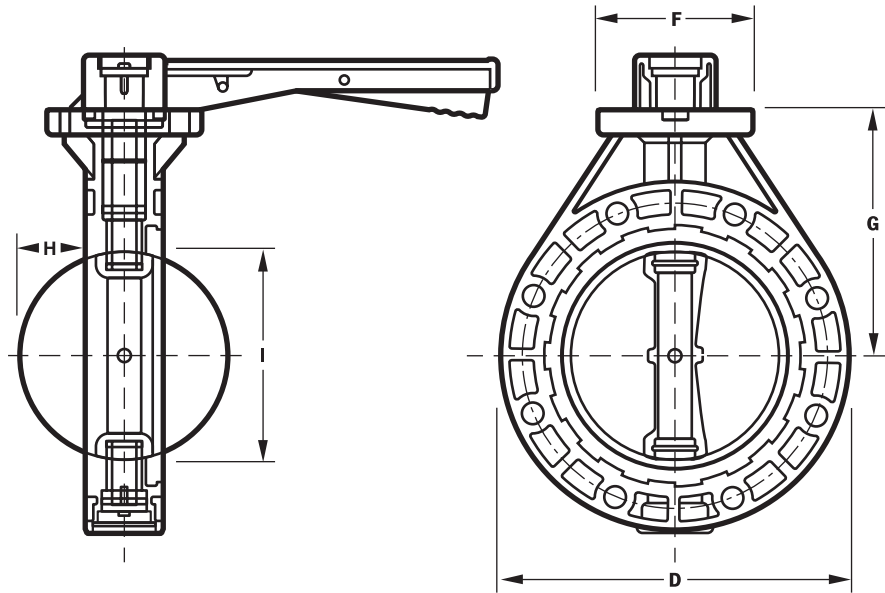
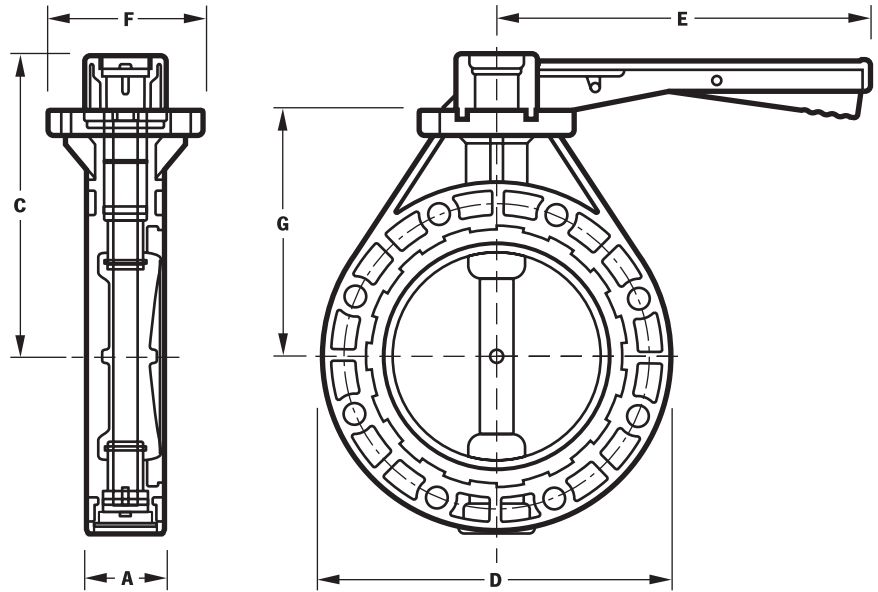

COMPRESSED AIR WARNING

The products in this catalog are only intended for use in transferring or storing chemically compatible pressurized liquids. **Do not test or use products in this catalog with compressed air or other gases.** Doing so is dangerous and could cause injury or great bodily harm should a system fail under compressed air. Only use products that are specifically designed for compressed air/gas service. Call Colonial technical service for more information.

AIR/GAS

BUTTERFLY VALVE DIMENSIONS

| | 8" |
|---|---------|
| A | 3 |
| C | 11-3/4 |
| D | 13-7/16 |
| E | 14-1/2 |
| F | 6 |
| G | 9-1/2 |

BUTTERFLY VALVE 90° OPEN

| | 8" |
|---|-------|
| H | 2-1/2 |
| I | 7-3/8 |

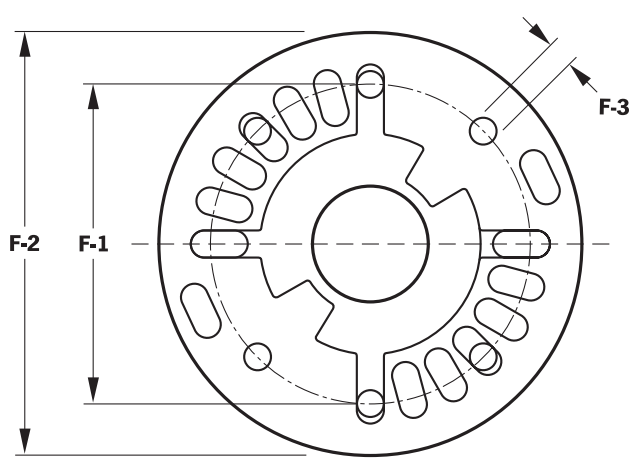

BUTTERFLY VALVE DIMENSIONS

| | 8" |
|-----|---------|
| F-1 | 4-1/2 |
| F-2 | 6 |
| F-3 | 13/32 |
| F-4 | 1 |
| F-5 | 3/16 |
| F-6 | 1-13/32 |

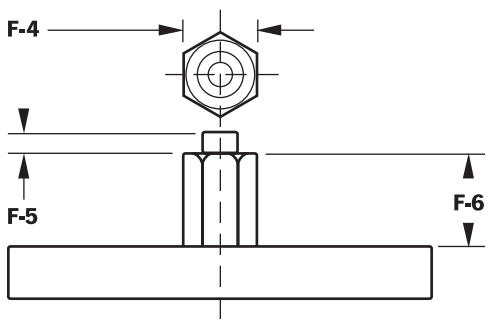

■ **Field Replaceable Face Seat**

Unique face seal retainer ring is easily and quickly removed for replacement of seal without the need of complete valve tear-down. Some competitor's valves require a hammer and chisel to remove the retainer ring. Not Colonial's. Just push and twist and the ring can be removed for easy seal replacement. Seal kits and complete valve overhaul kits available.

■ **Handle Included**

High impact-resistant ABS handle comes complete with built-in lock out feature.

■ **Full Face Contact Design**

The valve is designed with a full face contact area to mate-up perfectly with the outer rim of a plastic flange with user-supplied full face gaskets. This greatly reduces the chance of flange breakage due to unsupported areas.

■ **Optional Actuation or Gear Operators**

Optional electric and pneumatic actuation or gear operators can be purchased fully assembled and tested from the factory or easily field-retrofitted via the hex-shaped stem design.

FLANGE BOLT TIGHTENING PATTERN

Tighten bolts evenly while following numerical sequence.

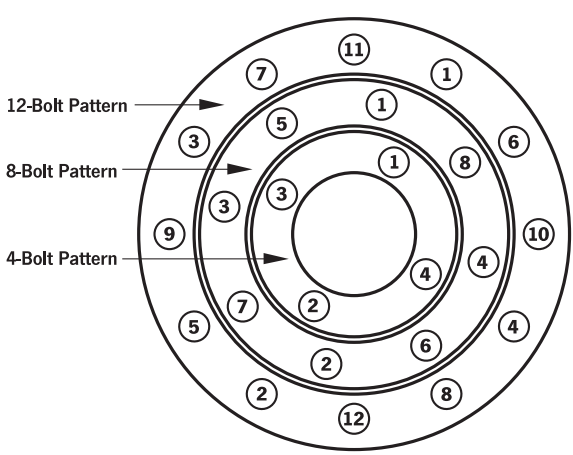

CAUTION

- Do not over-torque flange bolts.
- Use the proper bolt tightening sequence.
- Make sure the system is in proper alignment.
- Flanges should not be used to draw piping assemblies together.
- Flat washers must be used under every nut and bolt head.



STEM EXTENSIONS

Stem extensions are available for Colonial's 8" butterfly valve.

The extensions are ideally suited for buried or insulated piping applications and can be tailored to meet specific lengths.

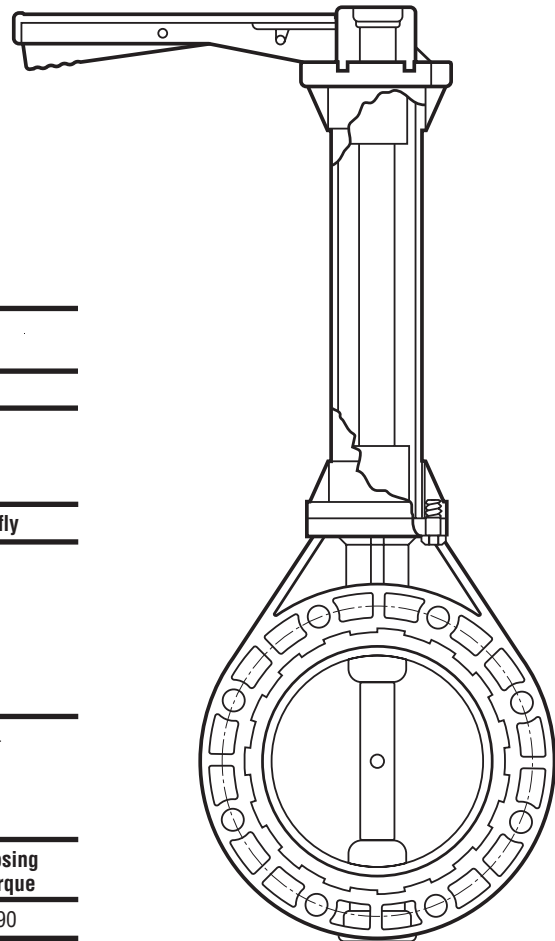

VALVE SIZE

| Valve Size | Part Number |
|------------|-------------|
| 8" | V80311N |

ACCESSORIES AVAILABLE

| | Butterfly |
|---------------------------------|-----------|
| Stem Extensions | X |
| 2" Operating Nut | X |
| Locking Handles | X |
| Gear Operators (Wheel or Chain) | X |

Please contact customer service for information.

TORQUE VALUES (ft-lbs)

| Valve Size | Opening Torque | Closing Torque |
|------------|----------------|----------------|
| 8" | 90 | 90 |

MAXIMUM PRESSURE/TEMPERATURE

See Table 4 (page 10) & Table 5 (page 11) for maximum pressure at various temperatures.

BOLT SPECIFICATIONS

| Pipe Size (in) | Number Flange Holes | USS Std. Hex Head Bolt Diameter (in) | USS Std. Hex Nut Size (in) | SAE Std. Flat Washer (in) Size O.D. | Rec. Torque (ft-lbs) |
|----------------|---------------------|--------------------------------------|----------------------------|-------------------------------------|----------------------|
| 8" | 8 | 3/4 | 3/4 | 3/4 1-1/2 | 30-40 |

FLUID FLOW COEFFICIENT Cv*

| Valve Size | Degrees/Open | | | | | |
|------------|--------------|-----|-----|-------|-------|-------|
| | 15° | 30° | 45° | 60° | 75° | 90° |
| 8" | 59 | 236 | 590 | 1,063 | 1,771 | 2,361 |

* Gallons per minute @ 1 psi pressure drop